

# Doyle "Fat-Boy" Vertical Blender Specifications

## DOYLE "FAT-BOY" VERTICAL BLENDERS (13 TON)

- DRIVE: FOOTE-JONES MODEL 8415 - CLASS III DRIVE - 24 HOURS
- MOTOR: 75 HP, 3 PHASE, 220 OR 440 VOLT
- AUGER: 44" - 26" TAPERED SCREW (Intake Speed: Approx. 4,000 - 4,500 lbs. per min. - Highest capacity in the Industry!)
- BOTTOM BEARING: 2 7/16" , 4 BOLT FLANGE BEARINGS
- EXTRA LARGE SALEM VALVE DISCHARGE GATE: MANUAL (Discharge Rate: 5 Tons per min.)
- EXTRA LARGE HOPPER - STANDARD 9 FT. WIDE
- BLENDER CONTAINER: 12 GAUGE # 304 STAINLESS STEEL, 102" DIAMETER
- TOP OF BLENDER: 3/16", 7 GAUGE #304 STAINLESS STEEL
- GEAR BOX SUPPORT: 3/8" FORMED I BEAM, #304 STAINLESS STEEL
- MOTOR MOUNT: 3/8" STAINLESS STEEL
- BLENDER LEGS: 8" x 8 3/16" FORMED #304 STAINLESS STEEL
- SCALE: 50,000 LB. KNIFE & PIVOT SCALE IN HEAVY DUTY MILD STEEL CONSTRUCTION
- SCALE APPROVAL: NTEP APPROVED #94-126A1 (Approved for ALL USA States, Legal for Trade)
- SCALE FRAME: 2" x 4" x 1/4" WALL - MILD STEEL
- S-TYPE LOADCELL: 10 K LOADCELL
- DIGITAL READOUT: RICE LAKE 420 HE - 2" LED DISPLAY



**Doyle Equipment Mfg. Co., Inc.**

4001 Broadway, P.O. Box 3024, Quincy, IL 62305

Toll Free: 800-788-8085 Fax: 217-223-3655

E-mail: [doyle@doylemfg.com](mailto:doyle@doylemfg.com) Web Site: [www.doylemfg.com](http://www.doylemfg.com)



# Doyle "Fat-Boy" Vertical Blender Specifications

Home of Worldwide Quality Blending, Conveying, Tending, & Spreading Products!

[www.doylemfg.com](http://www.doylemfg.com)

The Doyle "Fat-Boy" Vertical Blenders increase your blend capacities for filling large capacity spreaders, tenders, and trailers. These blenders makes quick work of your batch blending. The "Fat-Boy" series vertical blenders are perfect for blending dry prilled and granular materials. Requiring half the space of a conventional rotary style blender, any of our Vertical Blenders are an excellent choice for today's high volume, high capacity facilities.

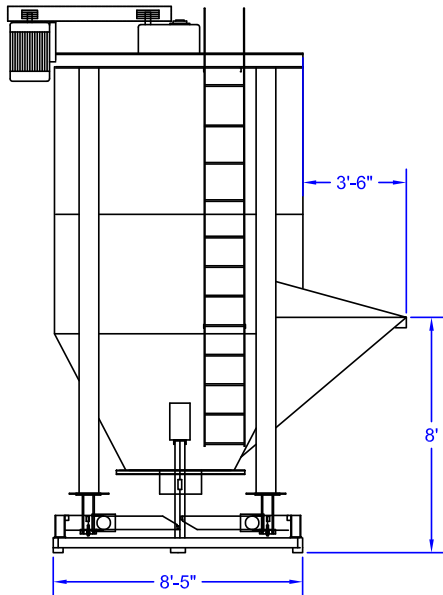

**Side View of "Fat-Boy" Vertical**

12 Gauge Tank Construction  
TEFC Motor & Enclosed Belt Guard  
4,000 to 4,500 lbs. Intake per min. \*\*  
10,000 lbs. Discharge per min. \*\*

\*\* = depends on material weight

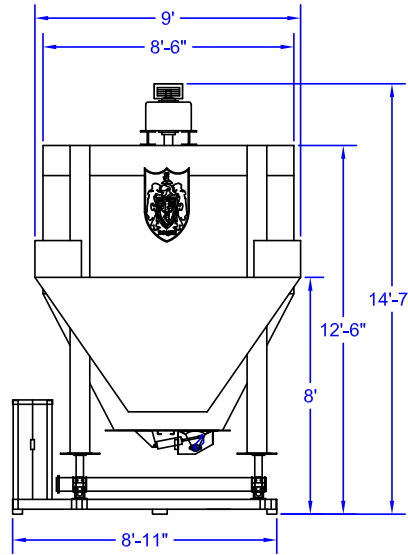

**10 Ton "Fat-Boy" Vertical**

60 HP Motor  
Class III Gearbox Drive  
44" to 26" Tapered Auger

Total Volume (water level):  
423 cu. ft. (12.7 tons @ 60 lbs. per cu ft.)

Working Volume:  
360 cu. ft. (10.8 tons @ 60 lbs. per cu ft.)

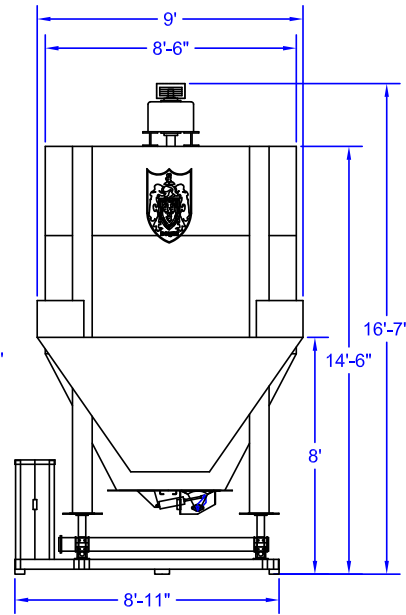

**13 Ton "Fat-Boy" Vertical**

75 HP Motor  
Class III Gearbox Drive  
44" to 26" Tapered Auger

Total Volume (water level):  
536 cu. ft. (16.1 tons @ 60 lbs. per cu ft.)

Working Volume:  
456 cu. ft. (13.7 tons @ 60 lbs. per cu ft.)

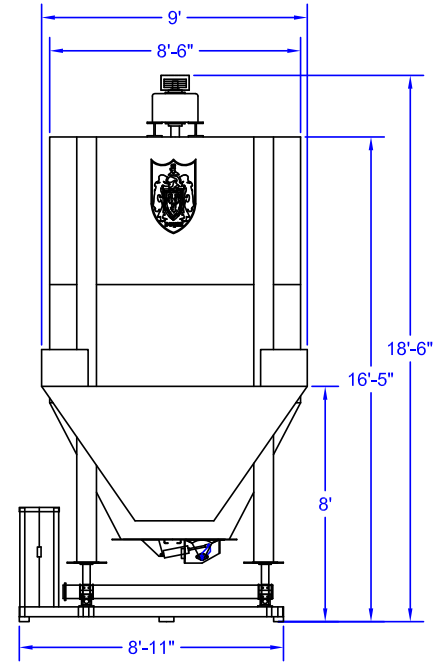

**16 Ton "Fat-Boy" Vertical**

100 HP Motor  
Class III Gearbox Drive  
44" to 26" Tapered Auger

Total Volume (water level):  
649 cu. ft. (19.5 tons @ 60 lbs. per cu ft.)

Working Volume:  
553 cu. ft. (16.6 tons @ 60 lbs. per cu ft.)